

**24 PAX CREW TRANSFER VESSEL
DAMEN FCS 2710
SEAZIP 9**



MV SeaZip 9 is a fast Twin Axe Bow catamaran for transport of Industrial Personnel, equipment and parts to offshore windfarms and oil & gas fields.

GENERAL

Year of construction	2020
Hull Material	Aluminium
Superstructure material	Aluminium
Basic functions	Crew and cargo duties
Classification	Bureau Veritas
Flag	Dutch
IMO Number	9887865

DIMENSIONS

Length overall:	26.8 m
Beam overall	10.5 m
Depth at sides	4.3 m
Draught max	2.3 m
Cargo deck area	90.0 m ²
Gross tonnage	235
PAX capacity	Up to 24 PAX

TANK CAPACITIES

Fuel oil	30.5 m ³
Fresh water	3.5 m ³
Sewage	0.5 m ³
Bilge water / dirty oil	0.4 m ³

PERFORMANCES

Speed	25 knots
Range at max. speed	1,200 nm

PROPULSION SYSTEM

Main engines	2x Caterpillar C32 TTA
Total power	Up to 2,162 bkW
Gearboxes	2x Reintjes ZWVSA series (two-speed)
Propulsion	2x Fixed pitch propeller
Bow thrusters	2x 64 kW, hydraulically driven

ELECTRICAL EQUIPMENT

Network	24V DC, 400/230V 50Hz AC
Generator sets	2x 38.0 ekW

DECK LAY-OUT

Anchor equipment	1x 150 kg SHHP Pool TW, Chain, electric winch
Fendering	Heavy-duty bow fender, rubber "D" type at sides
Maximum Deckload	1.5t/m

SHIP SYSTEMS

Ship systems are according to Class	
Fuel transfer system	2x pump, electrically driven
Engine room ventilation	2x Extraction fan, 8,000 m ³ /hr each (one fan in each engine room)
Air-conditioning	Up to 110,000 BTU/hr
Fire extinguishing	Novac 1230 in engine rooms

ACCOMMODATION

Bridge deck	Wheelhouse, crew mess
Main deck	Personnel area, crew cabins, wet gear room, pantry, mess room, sanitary spaces
Lower deck	Storage

NAUTICAL AND COMMUNICATION EQUIPMENT

Integrates navigation system	
Remote monitoring system	
Searchlight	
Radar (X-band)	
AIS	
Compass (Magnetic)	
Compass (GPS)	
Autopilot	
Echo Sounder	
Internal communications	
External communications (GMDSS A2)	
Weather system	



OPTIONAL

- Moonpool
- Hoisting equipment Foldable deck crane, up to 20 tm
- Rescue zone
- Rescue cradle
- Fuel cargo system
- Crew accommodation Up to 8 berths
- Cabins 2* Single cabins
 3* Double cabins
- Personnel accommodation Alternative seats (VIP),
 alternative layout

- Various navigation equipment
- CCTV system
- External communication GMDSS A3
- Data communication Iridium, V-SAT,
 Fleet broadband,
 4G, Wi-Fi system,
 LAN system

Some of the items in this specification are optional. Specification and general arrangement can be changed without notice.

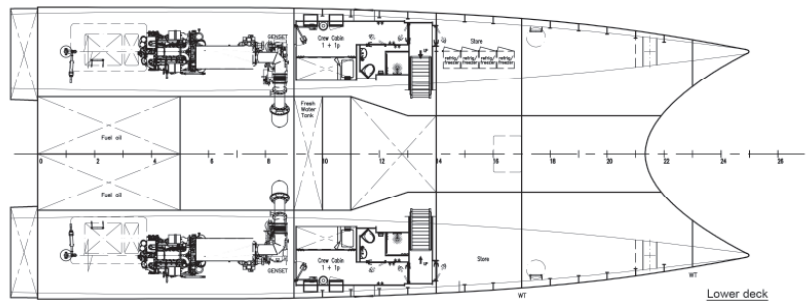
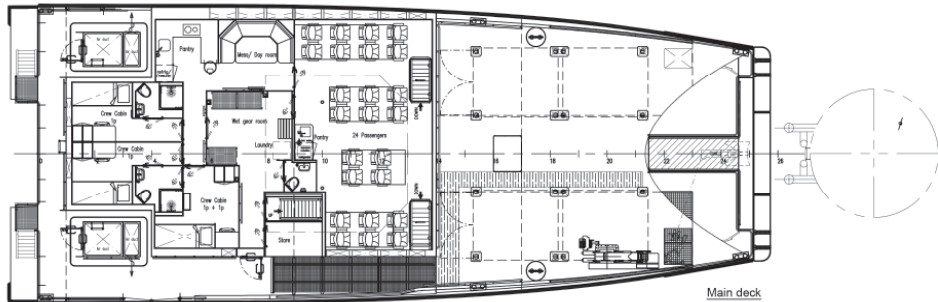
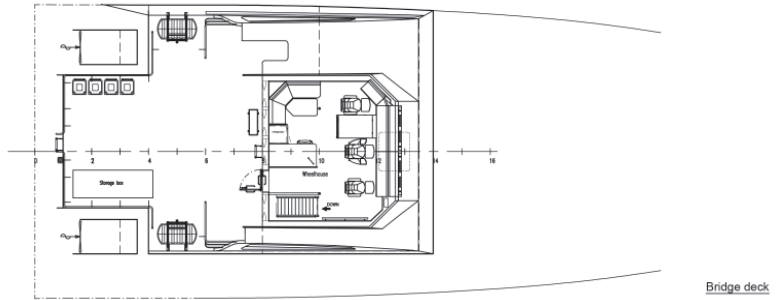
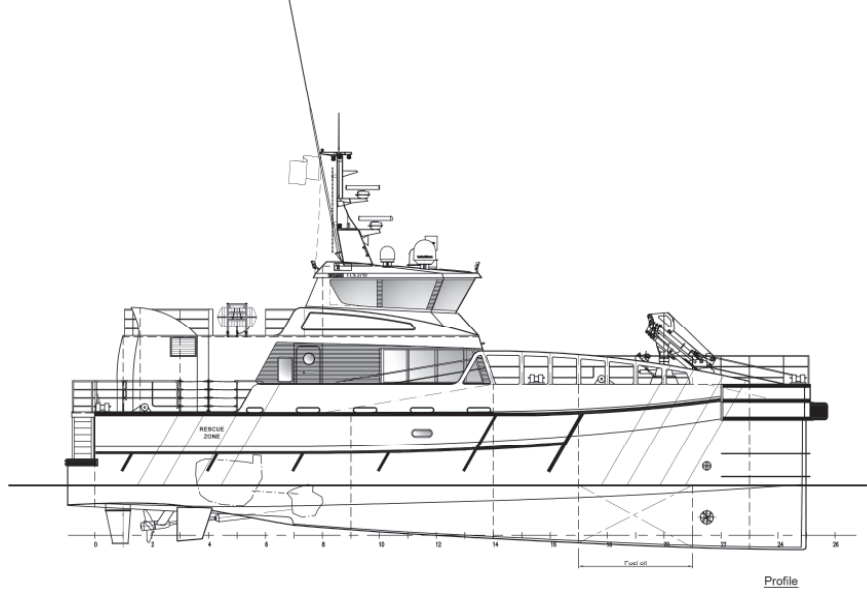

ABOUT THE SHIP MANAGER

The management of SeaZip vessels is carried out by the JR Shipping Group in Harlingen, The Netherlands, an experienced and all-round shipping company.

The shipping group operates a fleet of modern container feeders sailing under Dutch flag. JR Shipping cooperates closely with experienced maritime partners, several shipyards in the Netherlands and abroad, and renowned shipping bankers. JR Shipping is an efficient, flexible organisation, offering swift and effective solutions. We combine clout in ship development with well-secured quality and safety in ship management and an eye for sustainability.

www.jrshipping.com



HIGH PERFORMANCE, SAFE OFFSHORE OPERATIONS



Korte Lijnbaan 25
P.O. Box 3, 8860 AA Harlingen
The Netherlands

T + 31(0)517 431 225
info@seazip.com
www.seazip.com